

FOR SALE / TO LET



Unit 1 | Thistle Brewery | 2 Mill Road | Alloa | FK10 1JY

**Modern Ground Floor
Commercial Unit - 5,066sq.ft.**

**Griffin
Webster**
0141-248-7808

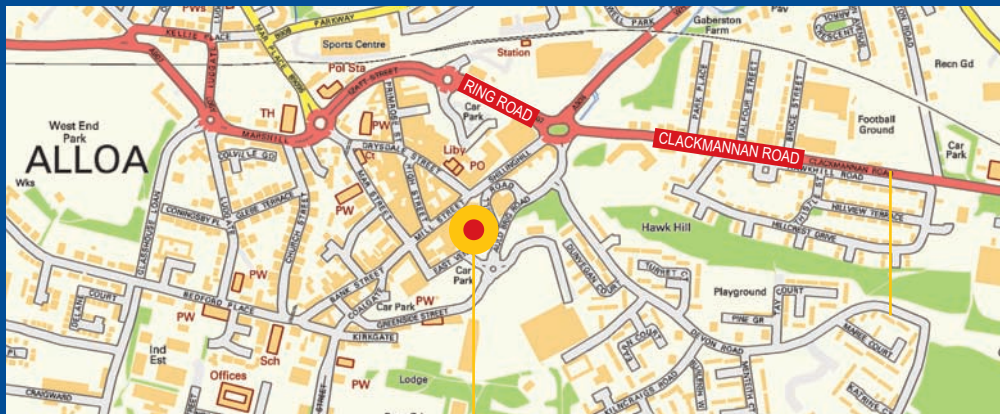

Location

The premises is located on Mill Road, adjacent to Bensons for Beds and opposite Argos. This is a secondary town location which forms part of Alloa's main retail pitch, nearby occupiers include Santander, Iceland, New Look, Ladbrokes & Thomson. The property also benefits from excellent parking within a few metres.

Description

Purpose built retail units with apartments above. The space is all ground floor and open plan with the layout designed such that there is masked sales/storage and as such a significantly more affordable rental and rates liability.

Floor Area

Ground Floor - 5066 sq ft - 470.64 sq m

Rating

The current assessment is RV £21,750, payable £11,000 approximately.

Lease Terms

New Fri lease of negotiable length, rental offers expected around £30,000 pa.

Sale Price

Offers invited for the heritable interest in the region of £295,000 ex VAT.

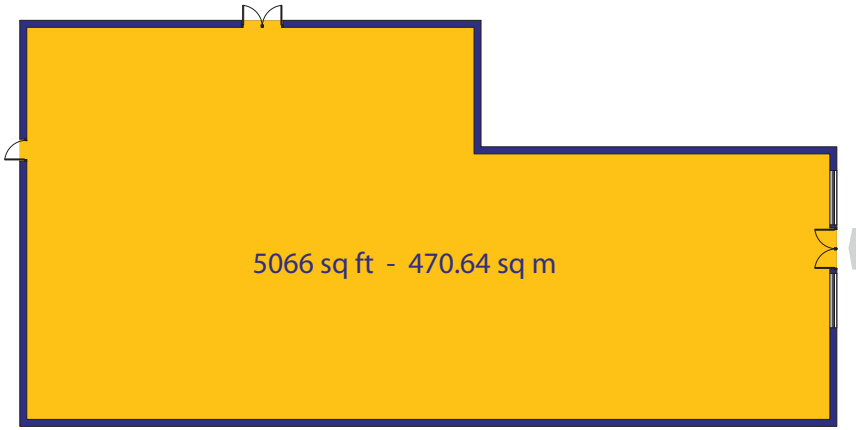

Further Information

For further details of viewing, site conditions, planning and disposal terms please contact sole agent:

David Griffin
Griffin Webster
T: 0141 248 7808
M: 07808 148 957
E: david@griffinwebster.co.uk



Important notice relating to the Misrepresentation Act 1967 and the Property Misdescriptions Act 1991: Griffin Webster, on its behalf and of to or after sellers of lessors of this property whose agents they are, give notice that: 1. the particulars are set out as a general outline only for guidance of intending purchasers or lessees and do not constitute, nor constitute part of, an offer or contract. 2. all descriptions, dimensions, references to condition and necessary permission for use and occupation, and other details are given in good faith and are believed to be correct, but any intending purchasers or tenants should not rely on them as statements or representations of fact, but must satisfy themselves by inspection or otherwise as to the correctness of each of them. 3. no person employed by Griffin Webster has any authority to make or give any representation or warranty to whatever in relation to this property.

Contains Ordnance Survey data © Crown copyright and database right 2018 Aug 2018